



# MC SERIES SINGLE-PHASE INDUCTION MOTOR WITH ALUMINIUM HOUSING

# MC SERIES SINGLE-PHASE INDUCTION MOTOR WITH ALUMINIUM HOUSING



**IMB3**

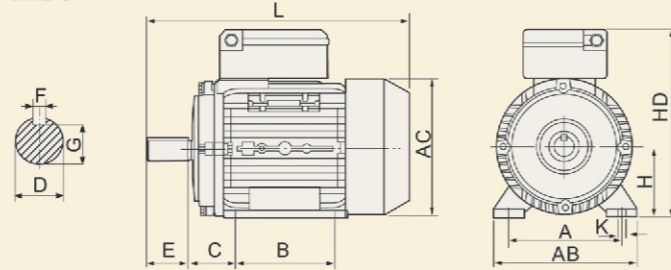

**IMB5**

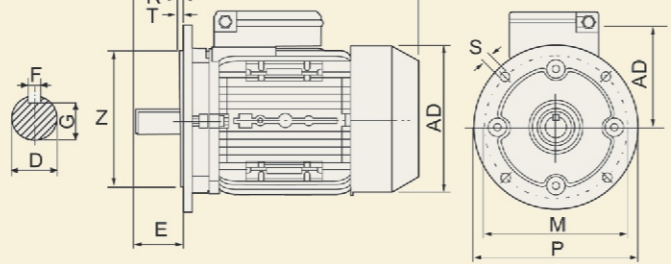

**IMB14**

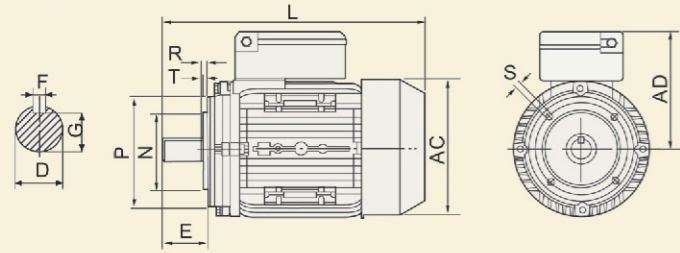

**MOTOR FEATURES**

- Utilise IP55 enclosures, others request
- Multiple feet locations
- Aluminum frame, end shields and base
- High strength cable gland
- Shaft key and protector supplied
- Superior paint finish
- Motors made to heavy duty service factors
- Can be made with stainless steel shaft
- Motors made with stainless S1 duty
- Utilise Vacuum impregnated Class B or class F insulation
- High performance and efficiency

**CUSTOMER BENEFITS**

- Water dust and vermin resistant
- Quiet operation
- Electricity saving
- Easy installation(bolt on feet) or brackets as required
- Corrosion resistant
- Corrosion resistant
- Dependable
- Superior life
- Reliable in country, city or factory environments

Frame Size	Mounting Dimensions(mm)																		Frame Dimensions (mm)							
										IMB14			IMB5													
	A	B	C	D	E	F	G	H	K	M	N	P	R	S	T	M	N	P	R	S	T	AB	AC	AD	HD	L
71	112	90	45	14	30	5	11	71	7	85	70	105	0	M6	2.5	130	110	160	0	10	3.5	145	145	125	205	255
80	125	100	50	19	40	6	15.5	80	10	100	80	120		M6	3.0	165	130	200		12	3.5	160	165	135	235	295
90S	140	100	56	24	50	8	20	90	10	115	95	140		M8	3.0	165	130	200		12	3.5	180	185	145	265	335
90L	140	125	56	24	50	8	20	90	10	115	95	140		M8	3.0	165	130	200		12	3.5	180	185	145	265	360
100L	160	140	63	28	60	8	24	100	12							215	180	250		15	4.0	205	215	170	280	380
112M	190	140	70	28	60	8	24	112	12							215	180	250		15	4.0	245	240	180	310	400

**Technical Data**

Model	Power (kw)	Voltage (V)	Current (A)	Speed (r.p.m)	Eff(%)	Power factor	Tstart /Tn	Tmax/Tn	Start current (A)	Net Weight (kg)
MC711-2	0.18	220	1.89	2800	60	0.72	3.0	1.8	12	6.5
MC712-2	0.25		2.40	2800	64	0.74	3.0		15	6.8
MC801-2	0.37		3.36	2800	65	0.77	2.8		21	8.3
MC802-2	0.55		4.65	2800	68	0.79	2.8		29	9
MC90S-2	0.75		6.09	2800	70	0.80	2.5		37	12.5
MC90L-2	1.10		8.68	2800	72	0.80	2.5		60	14
MC100L1-2	1.50		11.38	2800	74	0.81	2.5		80	22.5
MC100L2-2	2.20		16.46	2800	75	0.81	2.2		120	22.5
MC112M-2	3.00		21.88	2900	76	0.82	2.2		150	26
MC711-4	0.12		1.88	1400	50	0.58	3.0		9	6.5
MC712-4	0.18		2.49	1400	53	0.62	2.8		12	6.7
MC801-4	0.25		3.11	1400	58	0.63	2.8		15	8.9
MC802-4	0.37	4.24	1400	62	0.64	2.5	21	9.6		
MC90S-4	0.55	5.49	1400	66	0.69	2.5	29	12.5		
MC90L-4	0.75	6.87	1400	68	0.73	2.5	37	15		
MC100L1-4	1.10	9.52	1450	71	0.74	2.5	60	23		
MC100L2-4	1.50	12.45	1450	73	0.75	2.5	80	27		
MC112M-4	2.20	17.78	1450	74	0.76	2.5	120	35		